

# PIKE PINE STREETSCAPE AND BICYCLE IMPROVEMENTS

SEATTLE BICYCLE ADVISORY BOARD  
DESIGN UPDATE

October 6, 2021

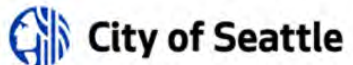

# PROJECT LIMITS

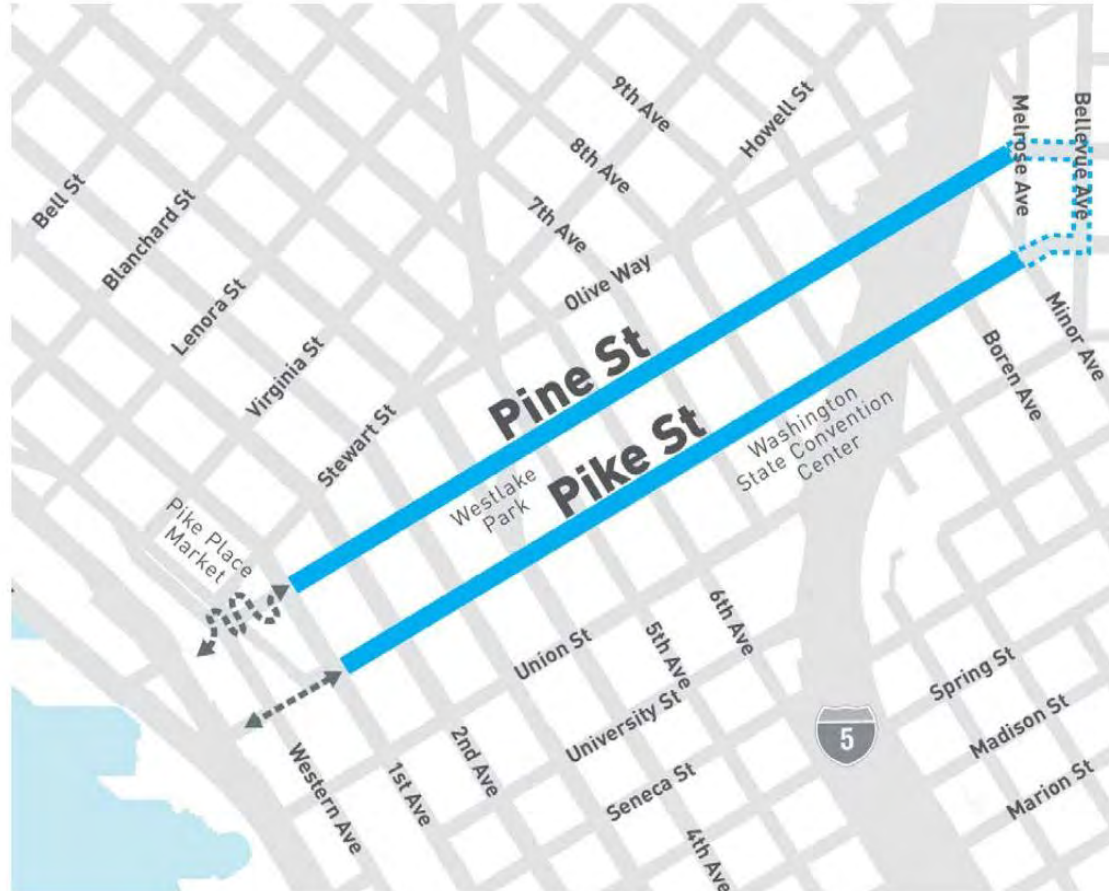

# IMPLEMENT PROTECTED BIKE LANES

- Provide safe and attractive protected bike lanes on Pike and Pine, serving a wide range of users and making key connections in the City's bike network

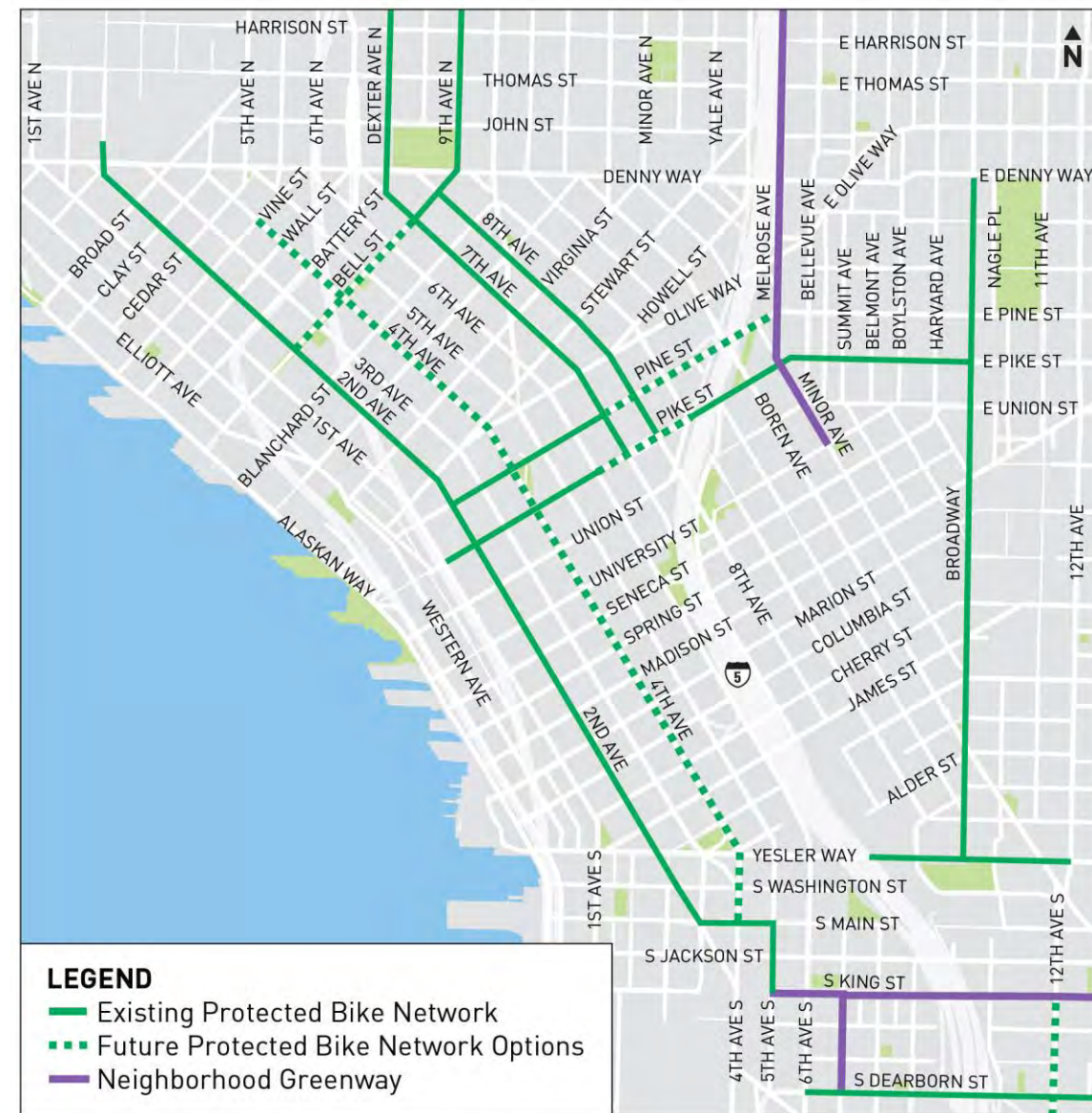

# SCHEDULE

## Pike Pine Streetscape and Bicycle Improvements Design and Construction Schedule:

- Complete 90% design and cost estimate – November 2021
- Complete 100% design – January 2022
- Projected construction start date – Fall 2022
- Construction anticipated to take 18 months

# CHANGES SINCE LAST SBAB PRESENTATION (JUNE 2020)

- Planted bike buffers changed to concrete buffers with planters east of 5th Avenue
- Integration of art elements to bicycle facilities
- Adjustments to signalization and bicyclist path of travel being studied at 5<sup>th</sup> & Pine/Westlake Park
- Redesigned PBL transition on Pike at Melrose/Bellevue
- 300 Pine design updated to focus on generous pedestrian connections and pick up/drop off



# PROTOTYPICAL BICYCLE FACILITY

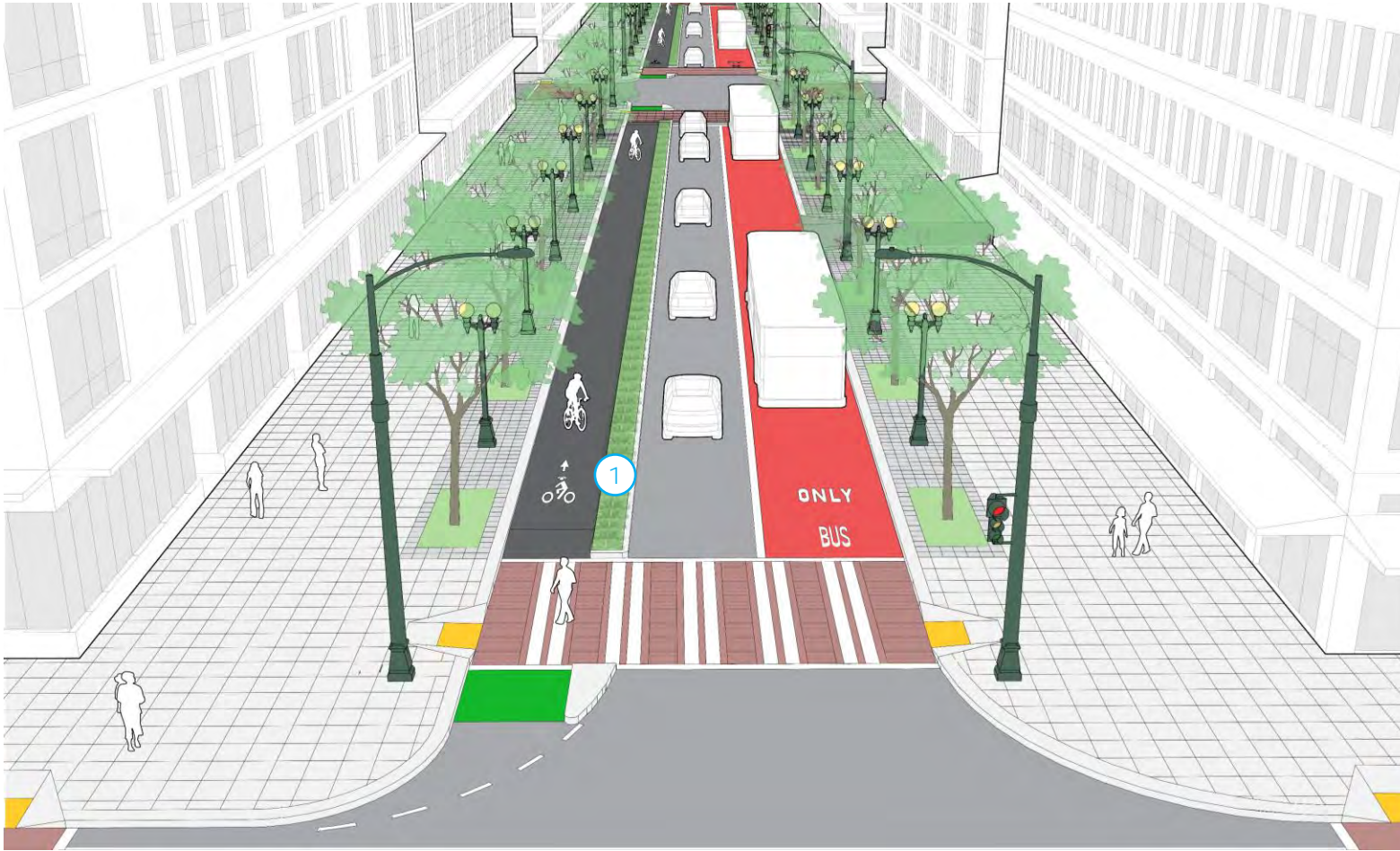

- ① Protected bike lane with buffer (in-ground plantings or concrete buffer with planters)

Public art (throughout)



# PLANTED BIKE LANE BUFFER WEST OF 5<sup>TH</sup> AVENUE





# CONCRETE BIKE LANE BUFFER EAST OF 5<sup>TH</sup> AVENUE





# INTEGRATED ART ALONG PROTECTED BICYCLE LANES

- Artist applied patterns are an element of continuity that appear on various bicycle facilities throughout the corridor

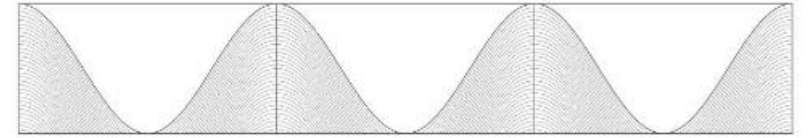
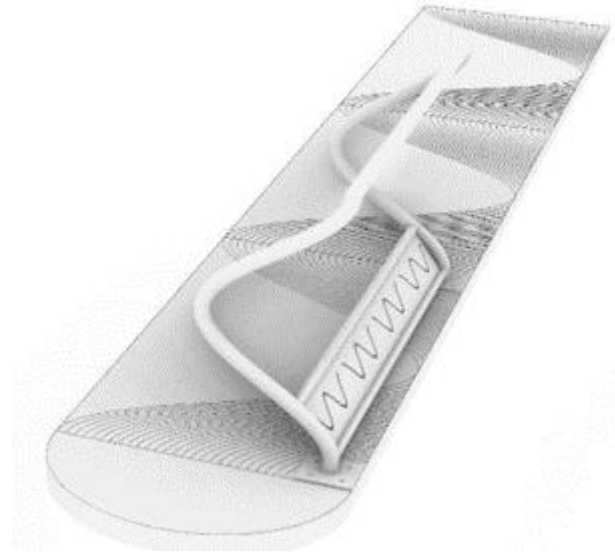
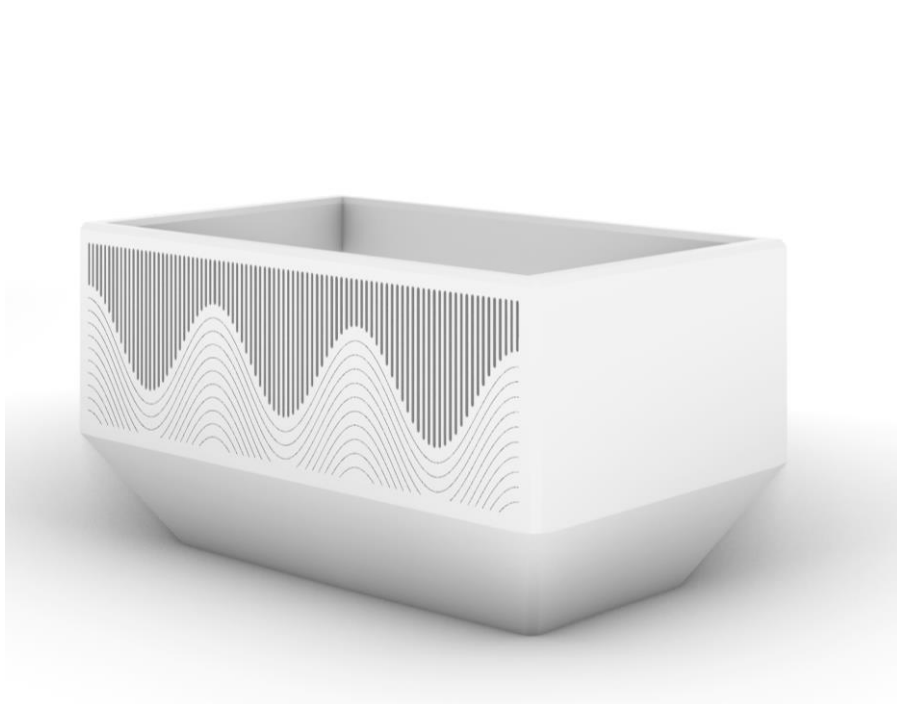



# PINE BRIDGE EXISTING





# PINE BRIDGE PROPOSED



Image courtesy of  
ZGF Architects in  
collaboration with  
LMN Architects.  
WSCCA likeness  
produced in  
collaboration with  
LMN Architects.



# 5<sup>TH</sup> & PINE/WESTLAKE PARK

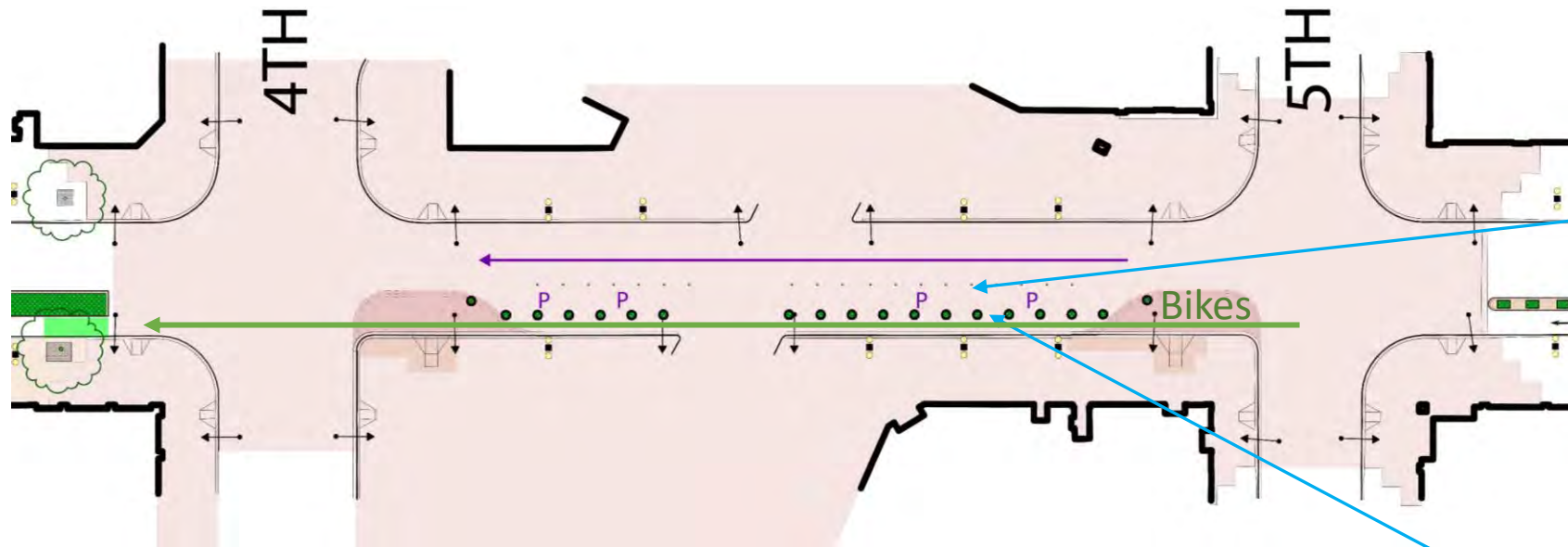

Buttons

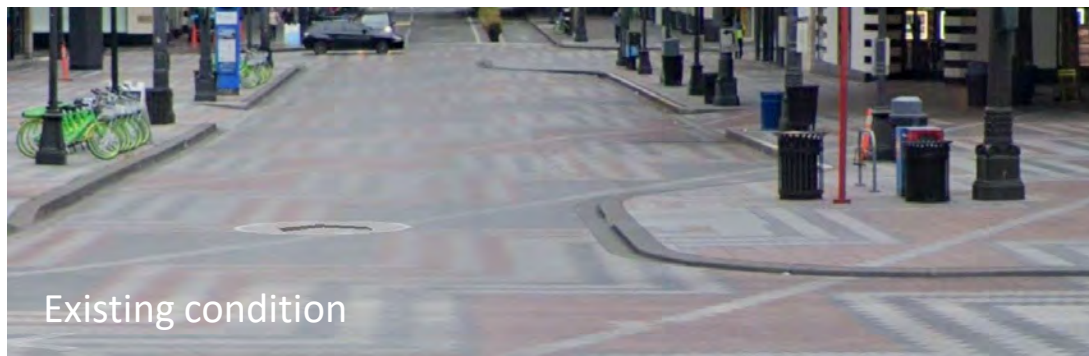

Existing condition

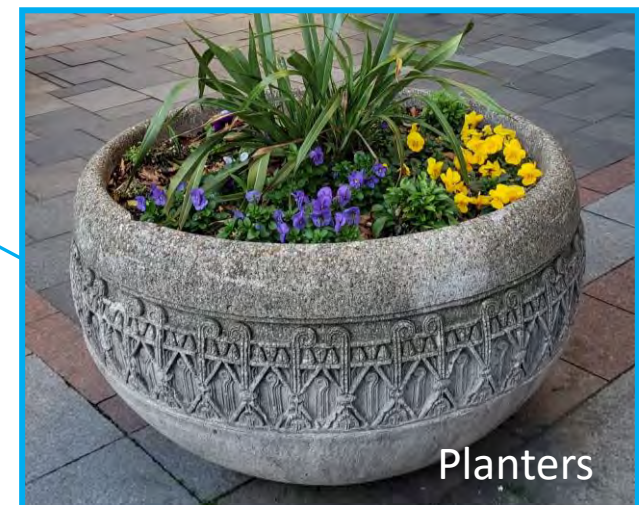

Planters



# COUPLET TRANSITION AT BELLEVUE AVENUE

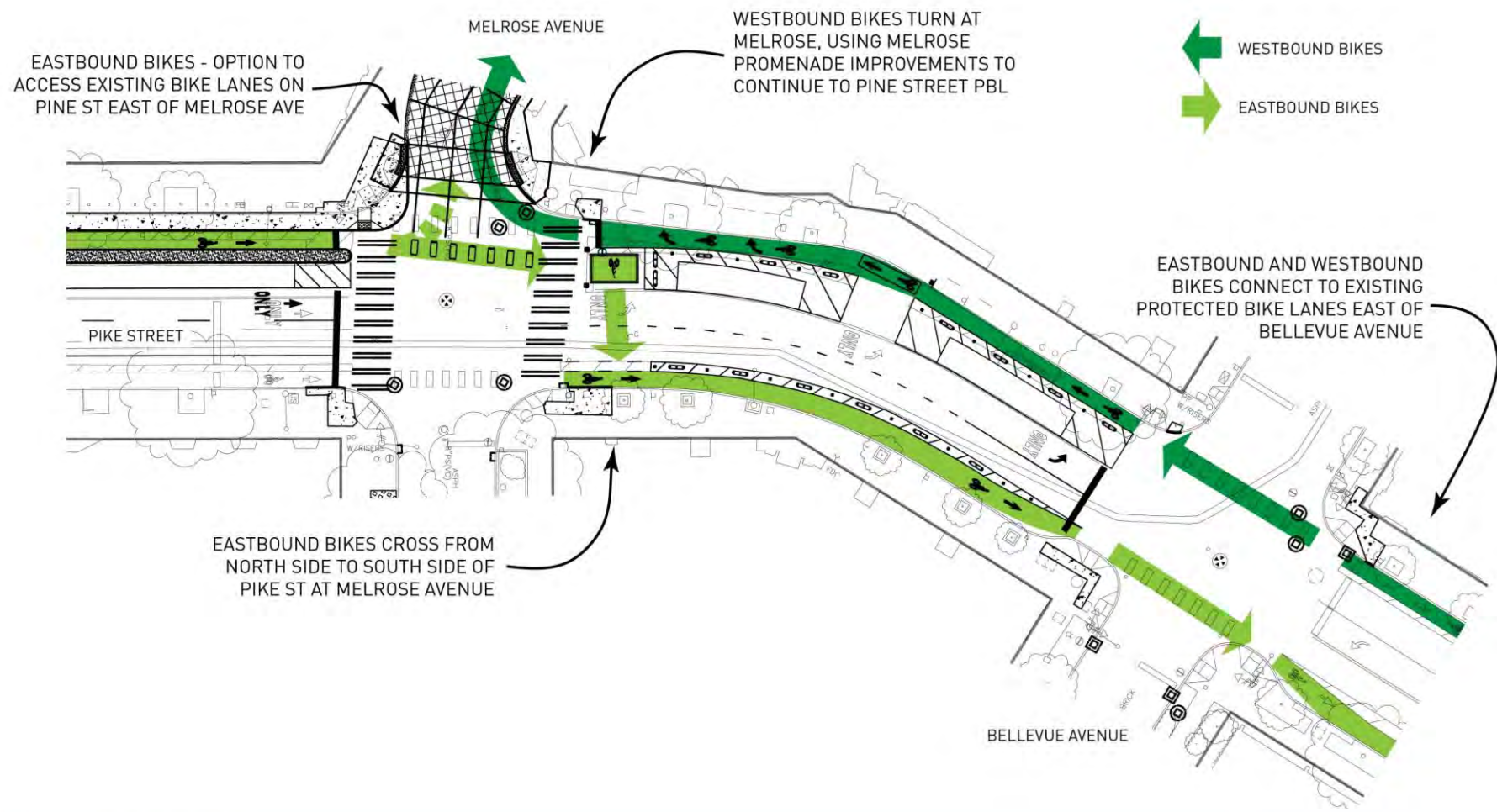



300 PINE EXISTING





# 300 PINE PROPOSED

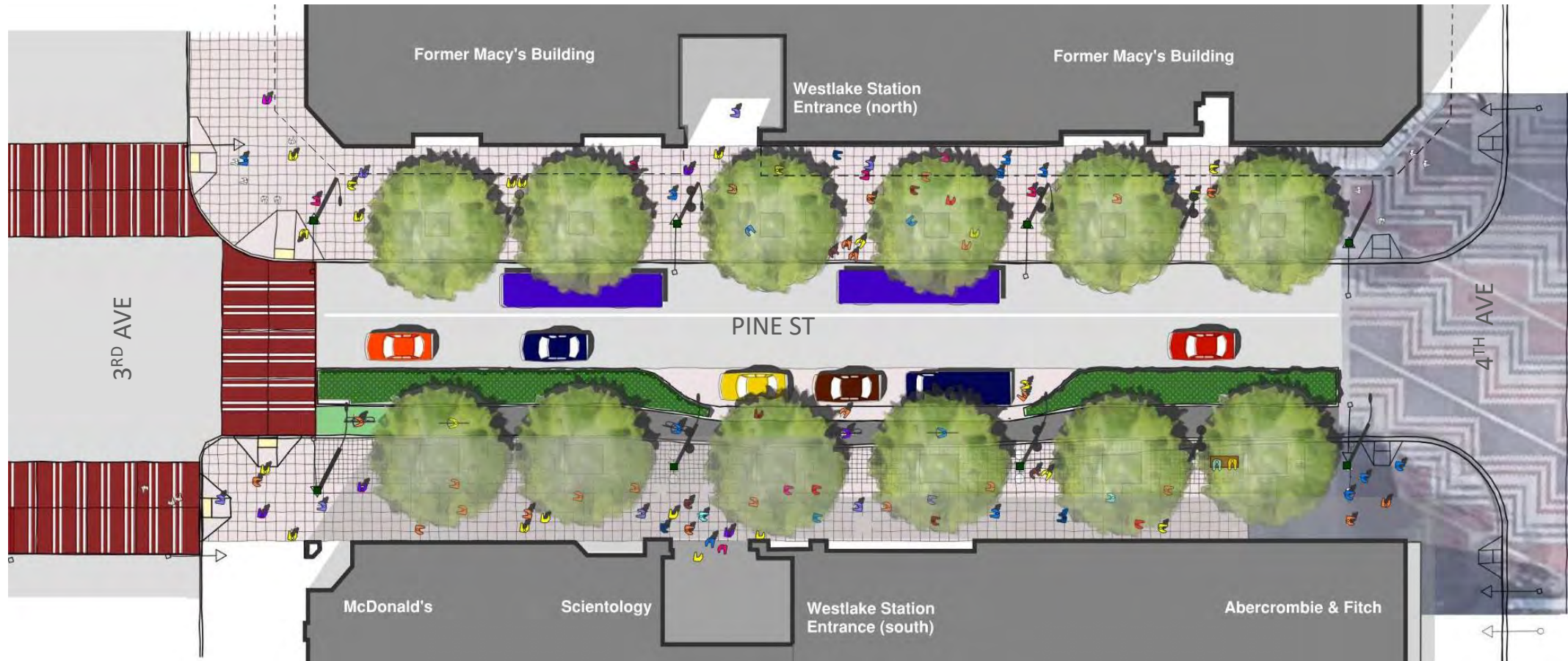

# 300 PINE

## SECTION THROUGH PLANTED BUFFER

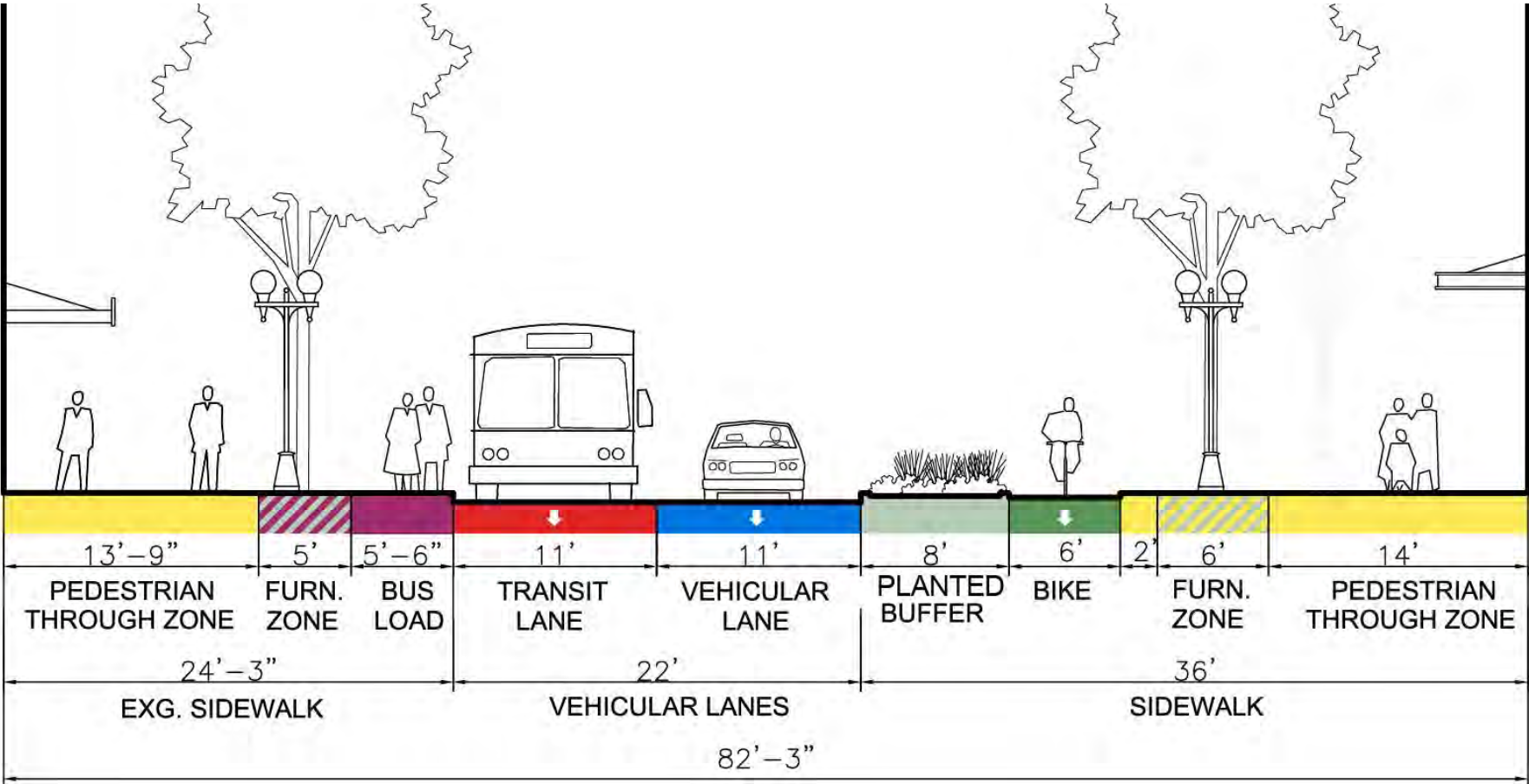
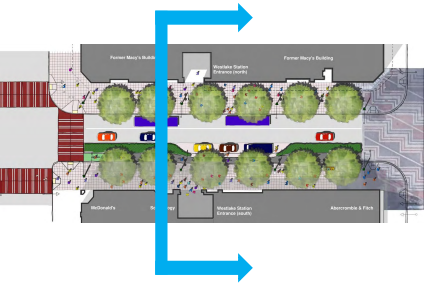

Section looking east



# 300 PINE

## SECTION THROUGH LOADING ZONE

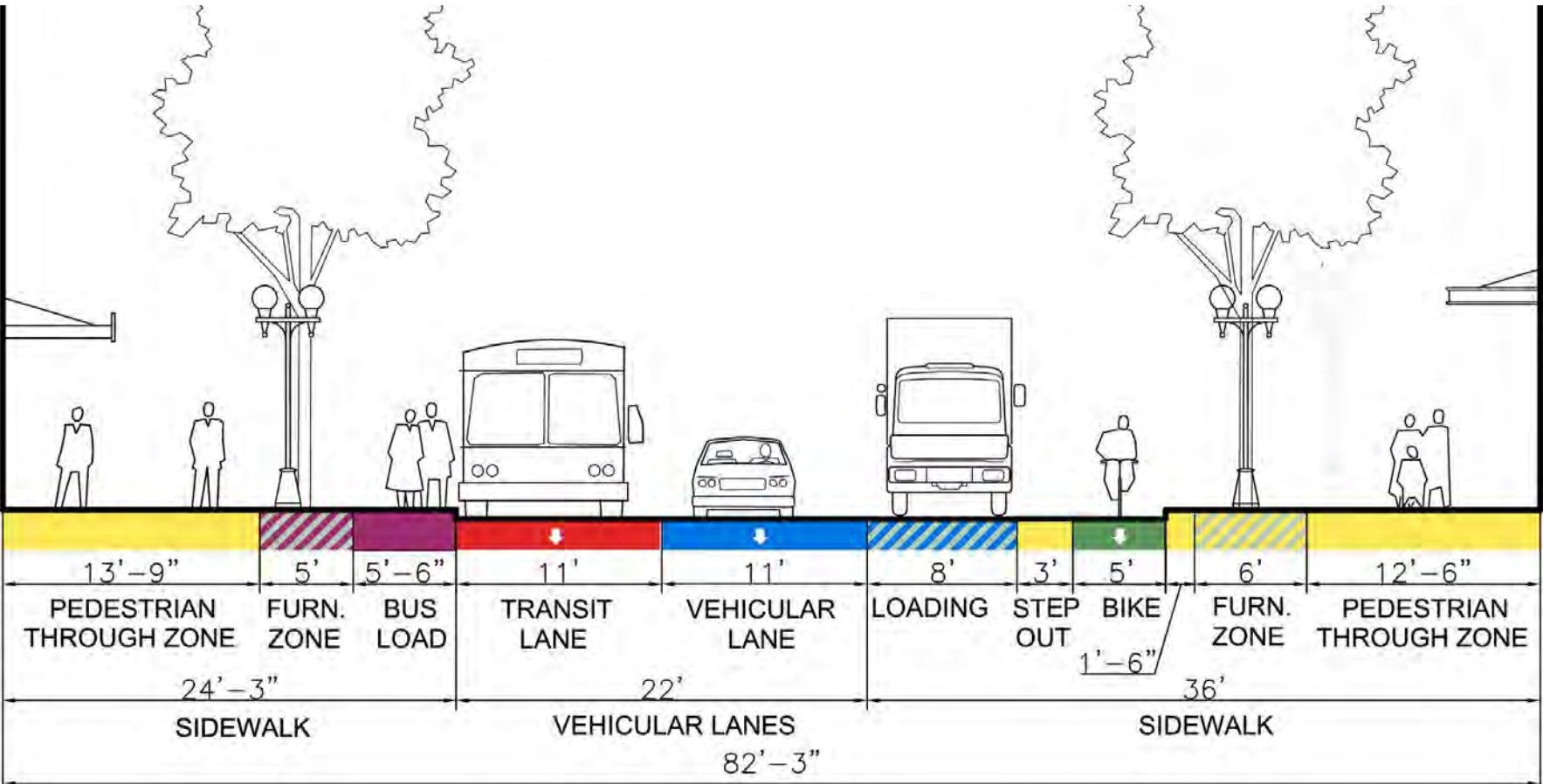
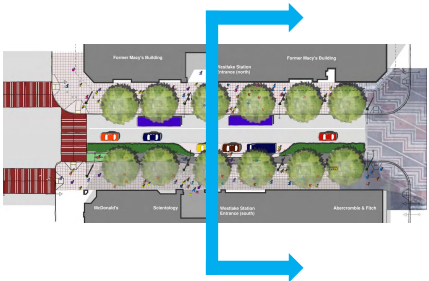

Section looking east



# 300 PINE





**QUESTIONS?**

# BUDGET SOURCES

